

Exploded

E1048 Power Cage

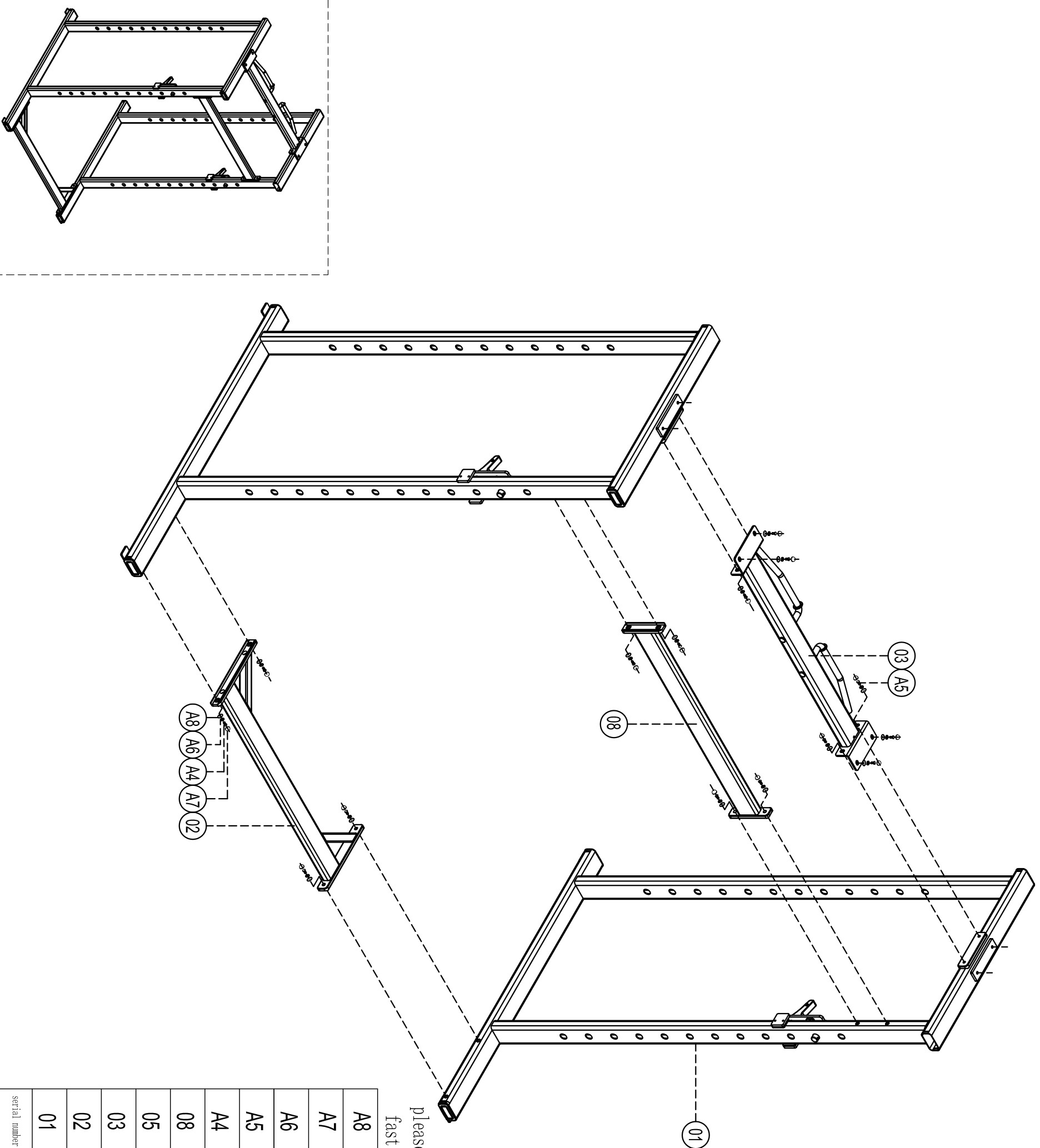

please note :prats didn't demolitionde part and fast eners not listde on the introduction

A8	Gasket $\phi 12 * \phi 30 * 11.5$	16
A7	Screw cap S277	16
A6	Spring washer $\phi 12$	16
A5	Outer hex screw M12*20	8
A4	Outer hex screw M12*35	8
08	Connector	1
05	Safety part	1
03	Top connector	1
02	Bottom connector	1
01	Main frame	2
serial number	name	quantity